

INDENTED STORAGE BAY FOR ONE BUS

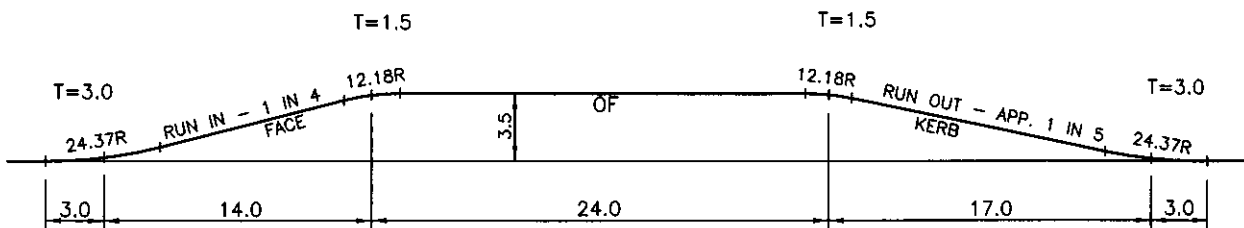

INDENTED STORAGE BAY FOR TWO BUSES

200mm THICK CONCRETE REINFORCED
WITH 2 LAYERS OF SL82 MESH.
(TOP AND BOTTOM; 50mm CLEAR COVER)

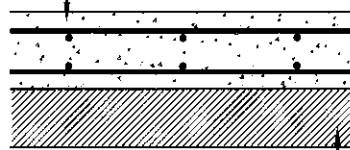

150mm LAYER OF COMPACTED
3% CEMENT TREATED CLASS 3 FCR

CROSS SECTION

NOTES:

1. CONCRETE STRENGTH 25MPa AT 28 DAYS.
2. SAW CUT WEAKENED PLANE JOINTS TO A DEPTH OF 30mm, 2 DAYS AFTER POURING.
3. FOR JOINT DETAILS REFER TO STD. DRAWING No. S 345.



INDENTED STORAGE BAY
FOR BUSES

APPROVED

[Signature]
MANAGER
ENGINEERING SERVICES

DRAWING No.

S415

DRAWN: M BASILE

CHECKED: S.Q

AMENDMENTS: SEPT 2015

SCALE: NTS

DATE: SEPT 2015

BY: MURRAY BASILE