

SERVICE PIT. TELSTRA,  
ELECTRICITY ETC.

MAX. 24m INTERVAL OR AS PER STANDARDS PRAM  
CROSSINGS AND VEHICLE CROSSINGS

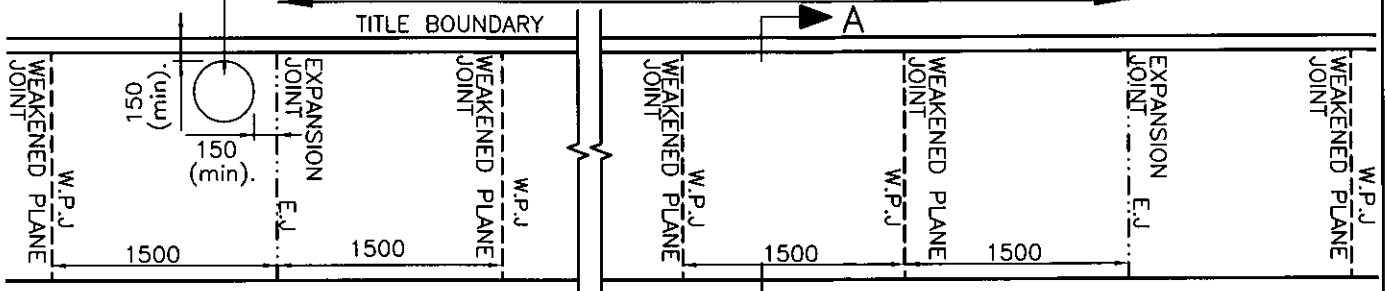

A PLAN NOT TO SCALE

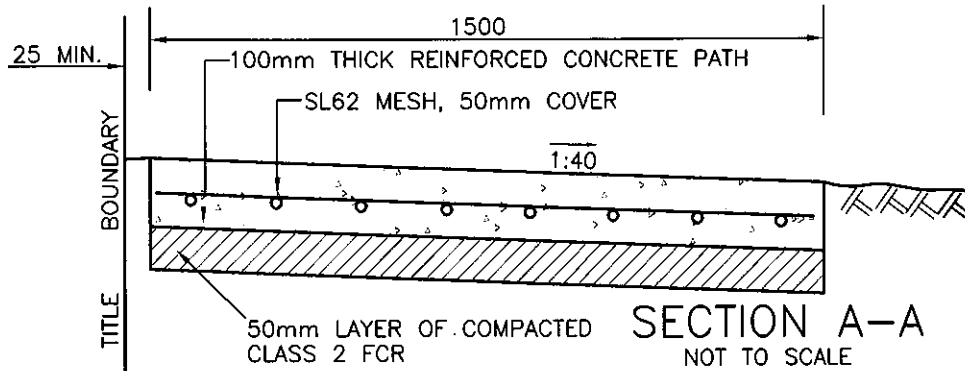

SECTION A-A NOT TO SCALE

WEAKENED PLANE JOINT REQUIRED EVERY 1500 (TOOL GROOVING) OR AS INDICATED ON IN THE CASE OF PRAM OR VEHICLE CROSSINGS.

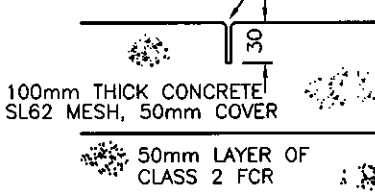

WEAKENED PLANE JOINT (TYPE 1)

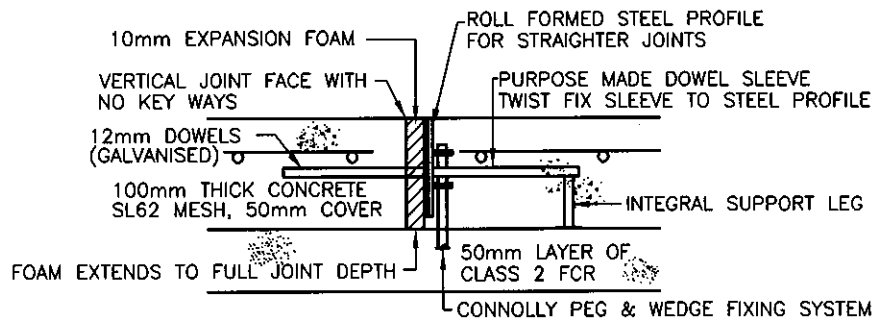

EXPANSION JOINT (CONNOLLY)

\*EXPANSION JOINTS EVERY 24m IN LENGTH.  
\*EXPANSION JOINTS ARE REQUIRED ON EITHER (BOTH) SIDES OF THICKENED SECTIONS ie VEHICLE CROSSINGS AND PRAM CROSSING.

NOTES:

1. WEAKENED PLANE JOINTS ARE REQUIRED AT EVERY 1500mm AND MADE FROM A GROOVING TOOL.
2. EXPANSION JOINTS ARE REQUIRED AT CORNERS, AT EVERY CHANGE OF GRADE, AT EVERY CHANGE IN PAVEMENT THICKNESS AND AT EVERY 24m INTERVAL AND AS PER PRAM CROSSING AND VEHICLE CROSSING STANDARD DRAWINGS.
3. CONCRETE STRENGTH 25MP<sub>d</sub> AT 28 DAYS. (TROWEL AND LIGHT BROOM FINISHED)
4. 25mm CLEARANCE SHALL BE MAINTAINED BETWEEN THE BACK EDGE OF FOOTPATH AND BUILDING LINE.
5. THE FOOTPATH MARGINS SHALL BE NEATLY TOOLED OFF TO A RADIUS OF 8mm AND BOTH SIDES OF ALL JOINTS SHALL BE EDGED WITH A SPECIAL TOOL FOR A WIDTH OF 40mm.
6. ALL REINFORCEMENT MESH MUST BE SUPPORTED BY BAR CHAIRS IN ACCORDANCE WITH AS3600.
7. DOWELS ARE TO BE INSTALLED B/W ANY NEW & EXISTING CONCRETE WHENEVER THE EXISTING CONCRETE DEPTH & CONDITION ALLOWS THE DRILLING & INSERTION OF BARS. 300mm LONG X 12mm THICK MILD STEEL DOWELS ARE TO SPACED AT 300mm CTS WITH COATED ENDS



CONCRETE FOOTPATH  
DETAILS

APPROVED

*[Signature]*  
MANAGER  
ENGINEERING SERVICES

DRAWING No.

S350

DRAWN: V. NGUYEN

CHECKED: S.Q

AMENDMENTS: SEPT 2015

SCALE: AS SHOWN

DATE: SEPT 2015

BY: MURRAY BASILE