

NOTE: ALL DIMENSIONS ARE IN MILLIMETRES

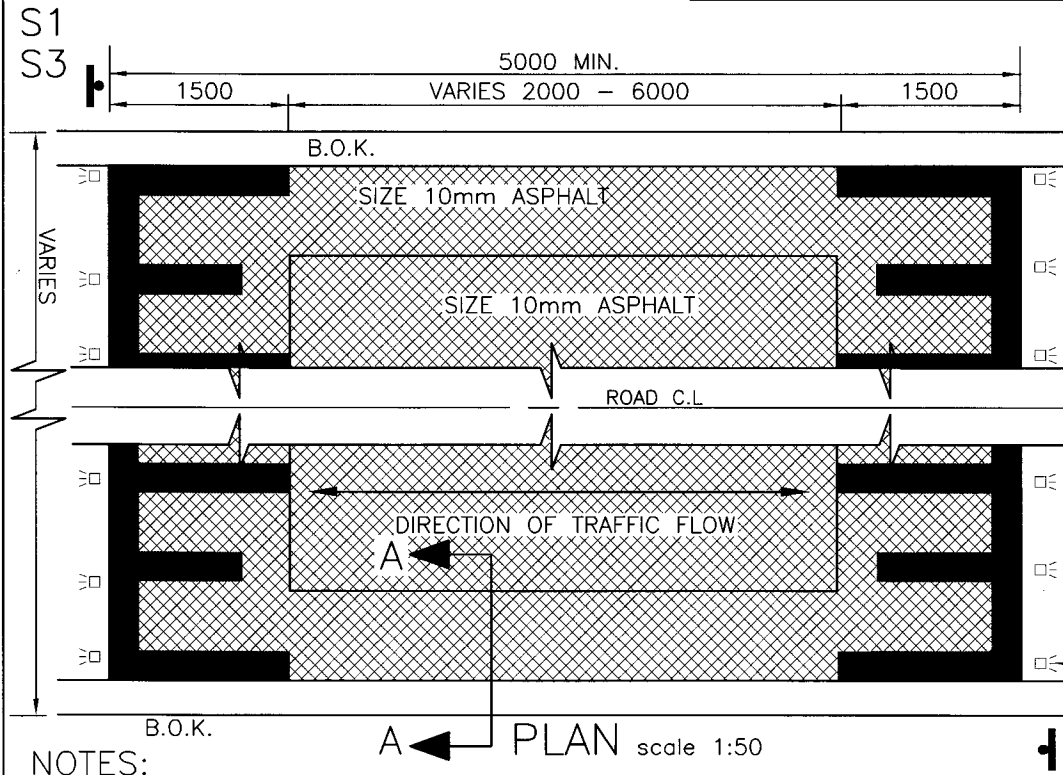

SIGNS(TYP.)

SIGN NO.	DESCRIPTION	NO. REQ.
S1	 W5-10A (CLASS 1)	2
S2	 W3-4A (CLASS 1) (APPROX. 50m FROM FIRST ROAD HUMP OF EACH DIRECTION OF TRAFFIC FLOW)	2
S3	 20 Km/h W8-2A (CLASS 1)	2

WHITE RRPM @500mm CTS

S1
S3

NOTES:

- STANDARD ROAD HUMP WARNING SIGNS, ROAD MARKERS AND RRPM's ARE REQUIRED TO SUPPLEMENT THE INSTALLATION OF THE ROAD HUMPS IN ACCORDANCE WITH THE CURRENT VICROADS TRAFFIC ENGINEERING MANUAL VOL-1, CHAPTER 8.
- ALL TRAFFIC MANAGEMENT DEVICES TO BE SUPPLEMENTED WITH ADEQUATE STREET LIGHTING.
- THE LENGTH OF THE FLAT TOP SECTION (2000-6000) TO BE APPROVED BY COUNCIL'S ENGINEERING DEPARTMENT.



STANDARD ROAD HUMP FLAT TOP TYPE 4 (BUS FRIENDLY HUMP)

DRAWN: M.BASILE	CHECKED: S.Q	AMENDMENTS:
SCALE: AS SHOWN	DATE: FEB 2023	BY:

APPROVED

[Signature]

MANAGER
ENGINEERING SERVICES

DRAWING No.
S408